



2026

Universal Hardware Product Catalog

***The Pro's Choice For Quality Commercial
Door Hardware***

universalhardware.com/ For for pricing and, special
orders, and custom keying please call (833) 3HD-LOCK / (833) 343-5625

About us

Universal Hardware delivers dependable mechanical door hardware designed for commercial jobs where durability, code compliance, and value matter most. As a trusted partner with The Home Depot for more than 15 years, we offer a broad assortment of locks, closers, and accessories suited for virtually any commercial environment.

Every product is constructed from high-strength materials and tested to meet or exceed industry standards—so you can specify and install with confidence. Our products are ideal for high-traffic applications including schools, churches, hotels, hospitals, office buildings, and multi-family housing.

Performance You Can Count On

All Universal Hardware locks and closers undergo extensive performance testing, including:

- Cycle testing
- Door impact testing
- Latchbolt strength testing
- Torque testing

Many models also meet ADA requirements and carry UL 10C fire ratings up to 3 hours, helping ensure compliance nationwide.

Whether you're upgrading security or outfitting new construction, Universal Hardware offers reliable, job-ready solutions that work as hard as you do.



To find the right hardware for your next project, visit the Pro Desk at The Home Depot.

PROGRAM OVERVIEW



Keying Services & Bulk Ordering



Comprehensive Commercial Hardware Program



Dedicated Service Reps

Custom Keying Services

We can work with your existing keyed system or develop a new one to meet your needs. Keying options range from:

- Keyed Alike
- Keyed Different
- Master Keyed
- Construction Keyed
- Master Construction Keyed
- Maison Keyed
- Grand Master Keyed
- Great Grand Master Keyed



Need Help?

- Live chat from 7:00 am to 4:00 pm PST at [universalhardware.com](https://www.universalhardware.com)
- By phone from 7:00 am to 4:00 pm PST at **833-343-5625**

Product specifications and installation videos available at, [universalhardware.com](https://www.universalhardware.com)

We Supply Multifamily and Commercial Property Pros

Facility Managers

Maintenance

Technicians

Locksmiths

Handymen

Contractors

Interior Door Accessories

Ball Bearing Door Hinges



Floor Mounted Door Stop



Floor Mounted
Door Stop with
Holder



Pull Plate
16"



Push Plate
16"



Interior Unit Door Locks

Light Duty Passage
Lever

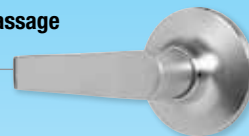

Light Duty Privacy
Lever

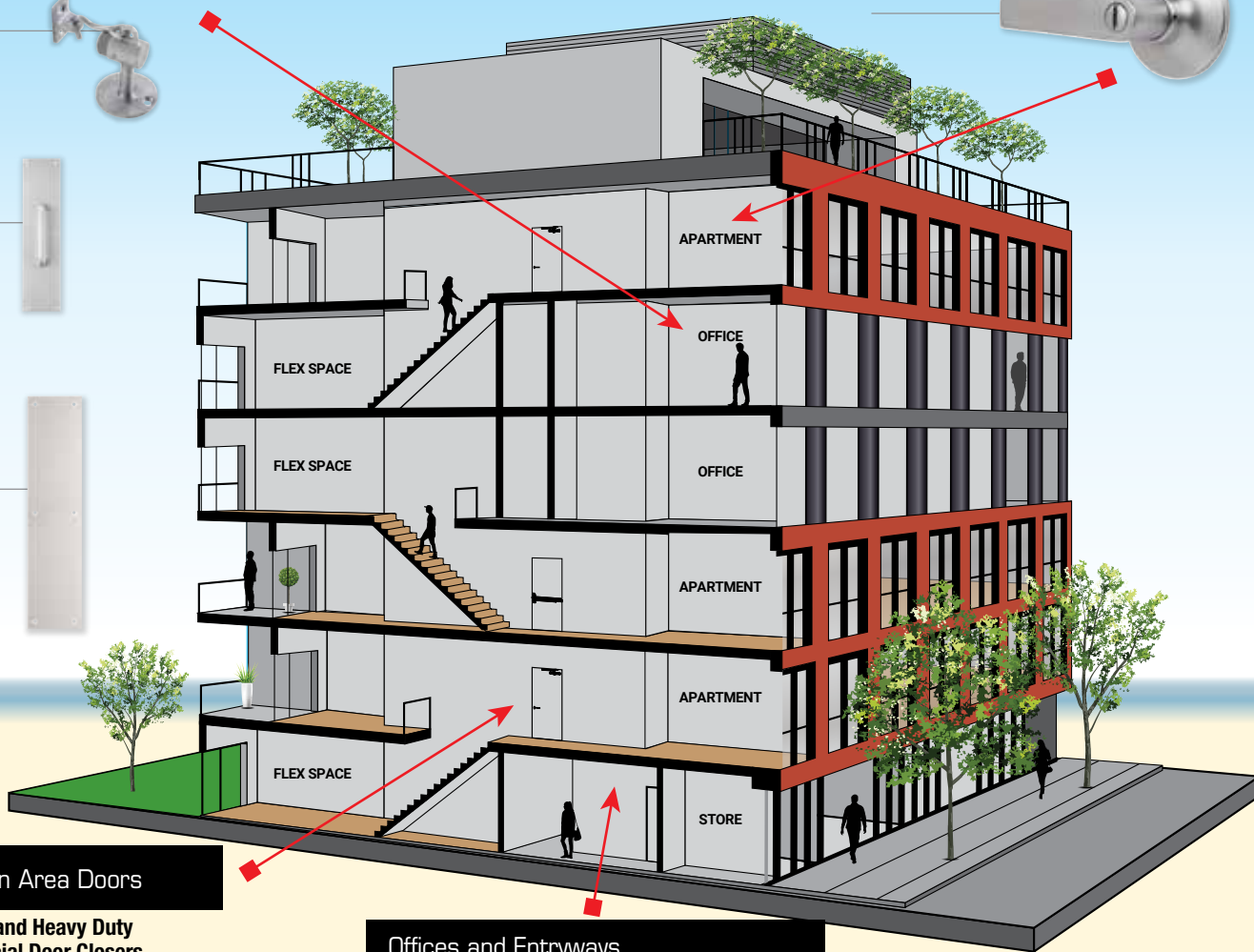

Common Area Doors

Medium and Heavy Duty
Commercial Door Closers

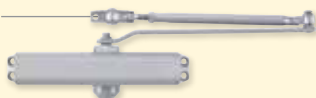

Exit/Panic Device



Exit Device Lever Trim



Offices and Entryways

Single Cylinder Deadbolt



Heavy Duty
Keyed Entry
Lever



Heavy Duty Commercial Door
Closer



Single Cylinder
Deadbolt



Light Duty
Keyed Entry
Lever



Table of Contents

Closers (surface mounted)	5
Commercial Closers.....	6
Residential Closers	10
Locksets	13
Lever/Knob Functions	14
Levers	15
Knobs	20
Knob & Deadbolt Combo	21
Deadbolt	22
Exit Device (and accessories).....	24
Exit Device (push bar)	25
Exit Device Trim (pull handle)	26
Exit Device Trim (pull handle)	27
Flat Goods & Accessories	28
Dome Floor Stop	29
Floor Stop with Holder	29
Kick Down Floor Stop	29
Hands Free Foot Door Opener.....	29
Commercial Grip With Arm Door Opener	29
Hands Free Arm Door Opener.....	29
Door Silencers.....	29
ASA Strike	30
Privacy Door Latch	30
4½" Ball Bearing Door Hinge.....	31
Spring Hinge	31
Pull Handle.....	32
Restroom Slide Latch	32
Restroom Indicator Latch	32
Restroom Door Hook	32
Pull/Push/Kick Plates	33
Pull Plates	34
Push Plates	34
Door Handles	36
"C" Style Pull Handle	37
"H" Style Pull Handle.....	37



Closers (surface mounted)

(UH4061)

Universal Hardware FlexPlate™ Door Closer Replacement Unlocked.

Avoid drilling new or unwanted holes in your commercial door with the Universal Hardware FlexPlate™ adapter, which attaches the plate to the existing holes in your door for seamless door closer replacement. This highly-adaptable plate matches >80% of competitor hole patterns found in the field.



	Description					
		All-In-One Heavy Duty Commercial Door Closer	Heavy Duty Commercial Door Closer	Medium Duty Commercial Door Closer	Heavy Duty Residential Door Closer	Light Duty Residential Hold Open Door Closer
Mounting	Case Pack Quantity	3	3	3	3	3
	Replacement or New Install	Replacement or New Installation	Replacement or New Installation	Replacement or New Installation	Replacement or New Installation	Replacement or New Installation
	Traffic Level	High Traffic	High Traffic	Medium Traffic	Medium Traffic	Low Traffic
	Standard (Pull)	✓	✓	✓	✓	N/A
Finish	Top Jamb (Push)	✓	✓	✓	✓	N/A
	Parallel Arm (Push)	✓	✓	✓	N/A	✓
Specs	Body Cover	Plastic	N/A	N/A	Plastic	Plastic
	Hold Open Engagement	N/A	N/A	N/A	N/A	80°
	Universal Mounting Plate	✓	N/A	N/A	N/A	N/A
	Body Material	Aluminum	Aluminum	Aluminum	Aluminum	Aluminum
	Adjustability	Adjustable closing, latching and backcheck speeds	Adjustable closing, latching and backcheck speeds	Adjustable closing and latching speeds	Adjustable closing speed	Adjustable closing speed
	ADA Compliant	✓	✓	N/A	N/A	✓
	Warranty	10 Year Limited	10 Year Limited	10 Year Limited	5 Year Limited	5 Year Limited
	UL 10C	3-Hour Fire	3-Hour Fire	3-Hour Fire	3-Hour Fire	N/A
	ANSI Grade	Grade 1	Grade 1			
	Closer Size	Adjustable 1 through 6	Adjustable 1 through 5	3	3	1
	Opening Range	180°	180°	180°	155°	180°
	Exterior Door Size	Up to 48"	Up to 42"	Up to 30"	Up to 30"	N/A
	Interior Door Size	Up to 60"	Up to 54"	Up to 38"	Up to 38"	Up to 30"

Closer Mounting Options

STANDARD MOUNT



PARALLEL MOUNT



TOP JAMB MOUNT





All-In-One Heavy Duty Commercial Closer with FlexPlate™



FINISH	MFG SKU	HD SKU
Aluminum	UH4071	1014197759
Bronze	UH4072	1014197760
Matte Black	UH4073	1014197761



Aluminum



Bronze



Matte Black

Parallel Arm (Push Side) Mounting

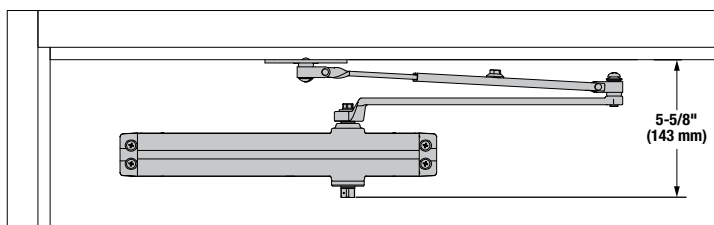
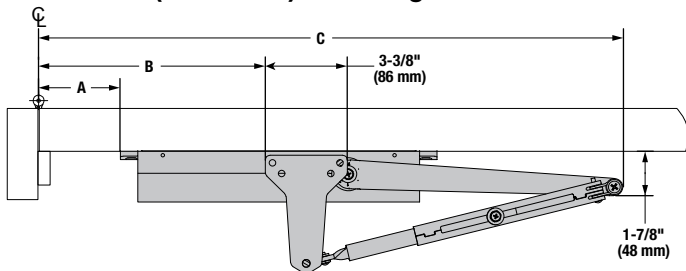

Specifications:

ANSI Grade 1

UL 3-Hour Fire Rated

Body: Aluminum (plastic cover)

Finishes: Aluminum (UH4071),
Matte Black (UH4073), Bronze (UH4072)

Closer Size: Adjustable 1 through 6

Opening Range:

Parallel: Up to 180-degrees

Standard: Up to 180-degrees

Top Jamb: Up to 180-degrees

Exterior Door Size: Up to 48"

Interior Door Size: Up to 60"

Universal
Mounting Plate
included



Opening Angle	A		B		C	
	in	mm	in	mm	in	mm
120°	3-5/16	84	9-3/16	233	23-3/4	603
180°	13/16	21	6-11/16	170	21-5/16	541

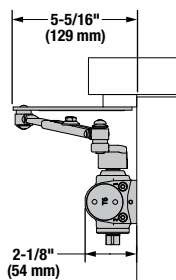

(List of compatible models for
FlexPlate can be found on next
page)

FlexPlate Hole Pattern Compatibility

STANLEY® Access Technologies

- D1650 Series
- D1651 Series

design hardware™

- 116 Series
- 316 Series
- 416 Series

ARROW™ LOCK & DOOR HARDWARE

ASSA ABLOY

- 900N Series
- 500N Series
- DC214 Series
- DC203 Series
- DC204 Series
- 5016N
- DC500

DELANEY™

- 4400 Series
- 6000 Series
- 8000 Series

SHIELD SECURITY

- 801201
- 801202
- 801204
- 801205
- 801207
- 909166
- 909168
- 909169

CALIBRE DOOR CLOSERS a Company of Influence that Promises to Serve You Well

- CA4000 Series
- CA5500 Series

DELTA TANA

- DC7
- DC10
- DC40
- DC50
- DC90

GLOBAL DOOR CONTROLS

- TC400 Series
- TC500 Series
- TC201
- TC4300
- TC2201ADA
- TC2200
- TC600
- TC4361
- DC70
- DC90

PDQ

- 1100 Series
- 3100 Series
- 5301
- 5501
- 7101

SARGENT

ASSA ABLOY

- 281 Series
- 351 Series
- 1130 Series
- 1331 Series
- 1430/1431 Series

PREMIER LOCK

- DC31 Series
- DC41 Series
- DC51 Series

International® door closers inc.

- 650/680 Series
- 750/780 Series
- 850/880 Series
- 5000/5050 Series
- 8050 Series
- 9000 Series
- 44CI Series
- 5000 Series
- 8051-TP

DEXTER COMMERCIAL HARDWARE

- DCH1000
- DCL2000
- DCM1000
- DCH4000

INDEPENDENCE

- 201 Series
- 611 Series

CRL

- PR40
- PR80
- PR90

Tell DOORS & HARDWARE

- 300 Series
- 500 Series
- 600 Series
- 800 Series
- 900 Series

BEST

dormakaba Group

- SL6000 Series
- HD7000 Series
- HD8000 Series
- HD7016
- HD8016
- SL6014
- EHD9000/EHD9016
- HF8056
- SL6036

Yale

- 150 Series
- 1400 Series
- 2300 Series
- 2500 Series
- 3100 Series
- 3300/3301 Series
- 3500 Series
- 5100 Series
- SC4400 Series
- SC400 Series
- 1101BF
- 1900
- 2701
- 51
- YDC201
- 5800
- 2721
- 2731
- 3521
- 3531
- 3581

L.I.F. INDUSTRIES, INC.

- Grade 3 MD
- Grade 2 HD

dormakaba

- 7300 Series
- 7400 Series
- 7414
- 7436
- 8616
- 8916
- 8956

LCN

- 1000 Series
- 1260 Series
- 1460 Series
- 4040 Series
- 1250
- 1261
- 1450
- 4011
- 4021
- 4031
- 4041
- 4050
- 4111
- 4010
- 4020
- 4110

Corbin Russwin

ASSA ABLOY

- DC3000 Series
- DC6000 Series
- DC8000 Series
- DC3200
- DC3220
- DC3600
- DC3219
- DC5200
- DC6200
- DC6210
- DC8200
- DC8210

TRU DOOR

- TDC 100
- TDC 300
- TDC 400

FALCON

- SC60 Series
- SC70 Series
- SC80 Series

IR DOR-O-MATIC

- SC60 Series
- SC80 Series

CAL-ROYAL PRODUCTS, INC. U.S.A.

- 300 Series
- 441 Series
- 700 Series
- 300PBF
- 500PBF
- N900PBF
- 800

HAGER COMPANIES

- 5100 Series
- 5200 Series
- 5300 Series

NORTON RIXSON

ASSA ABLOY

- 1600/1601 Series
- 7500/7700 Series
- 8100/8300/8500 Series
- 9300/9500 Series
- 410
- 210
- 1700
- 78BF

TownSteel

- TDC-70
- TDC-54
- TDC-85
- TDC-40

Doormerica

- DC70
- DC851
- DC40

RYOBI

- 1650 Series
- 3500 Series



Heavy Duty Commercial Closer



**3 HOUR
FIRE
RATED**



FINISH	MFG SKU	HD SKU
Aluminum	UH4031	666064
Bronze	UH4032	666097
Matte Black	UH4033	1008626498



Aluminum



Bronze



Matte Black

Specifications:

ANSI Grade 1

UL 3-Hour Fire Rated

Body: Aluminum

Closer Size: Adjustable 1 through 5

Opening Range:

Parallel: Up to 180-degrees

Standard: Up to 180-degrees

Top Jamb: Up to 180-degrees

Exterior Door Size: Up to 42"

Interior Door Size: Up to 54"

Parallel Arm Installation

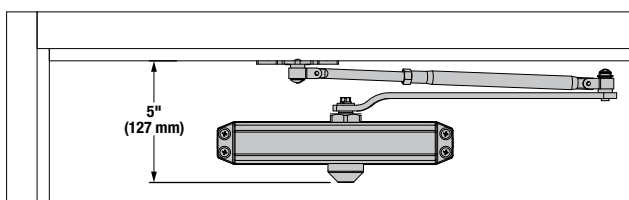
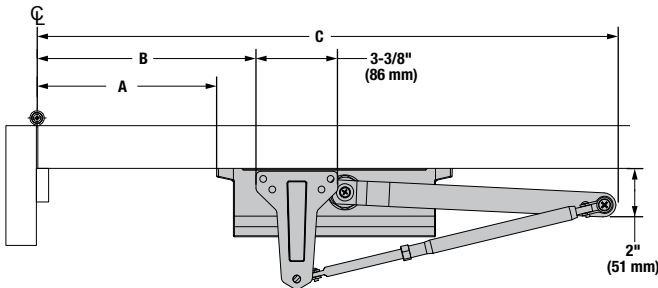

Opening Angle	A		B		C	
	in	mm	in	mm	in	mm
100°	7-5/16	186	8-15/16	227	23-11/16	602
120°	5-7/8	149	7-1/2	190	22-3/16	564
180°	3-13/16	97	5-7/16	138	20-3/16	513

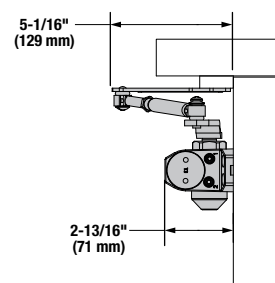



Medium Duty Commercial Closer



**3 HOUR
FIRE
RATED**



FINISH	MFG SKU	HD SKU
Aluminum	UH4051	666472
Bronze	UH4052	666498
Matte Black	UH4053	1008626563

Specifications:

UL 3-Hour Fire Rated

Body: Aluminum

Closer Size: 3

Opening Range:

Parallel: Up to 180-degrees

Standard: Up to 180-degrees

Top Jamb: Up to 180-degrees

Exterior Door Size: Up to 30"

Interior Door Size: Up to 38"



Aluminum



Bronze



Matte Black

Parallel Arm Installation

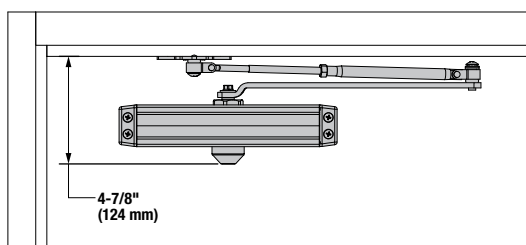
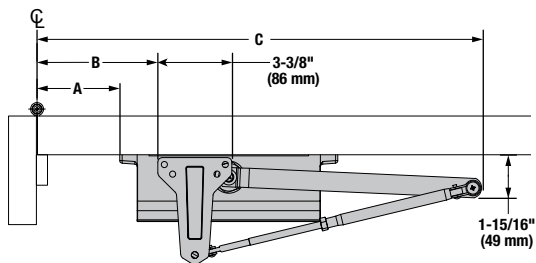

Opening Angle	A		B		C	
	in	mm	in	mm	in	mm
100°	7-1/4	184	8-15/16	227	23-9/16	559
130°	5-3/4	146	7-1/2	190	22-1/16	560
180°	3-3/4	95	5-7/16	138	20-1/16	510

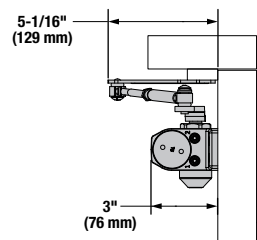



Heavy Duty Residential Closer



**3 HOUR
FIRE
RATED**



FINISH	MFG SKU	HD SKU
White	UH4007	1006601943
Matte Black	UH4008	1006601944

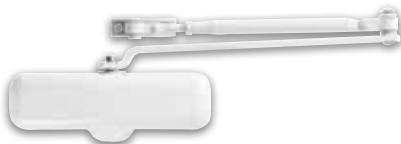

White



Matte Black

Specifications:

UL 3-Hour Fire Rated
Body: Aluminum (plastic cover)
Closer Size: 3
Opening Range:
Standard: Up to 155-degrees
Top Jamb: Up to 155-degrees
Exterior Door Size: Up to 30"
Interior Door Size: Up to 38"

Standard (Pull Side) Mounting (Cover Not Shown)

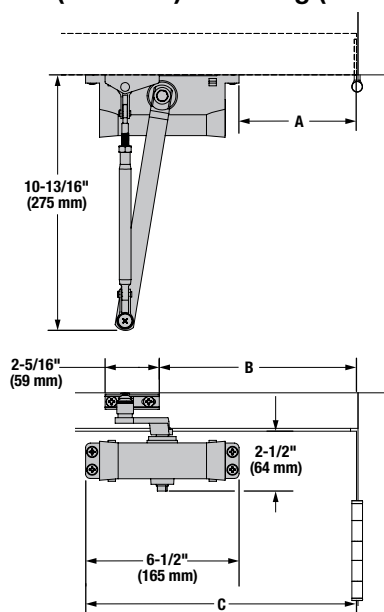

Opening Angle	A		B		C	
	in	mm	in	mm	in	mm
120°	4-15/16	125	8-5/16	211	11-1/2	292
155°	2-3/16	56	5-9/16	141	8-3/4	222

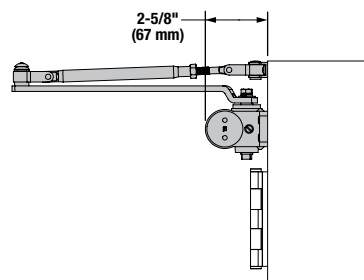



Light Duty
Residential Closer



**HOLD
OPEN**



FINISH	MFG SKU	HD SKU
White	UH4009	1007012002
Matte Black	UH4010	1006908689

Specifications:

Body: Aluminum (plastic cover)

Closer Size: 1

Opening Range: 180°

Automatic Hold Open Engagement: 80°

Exterior Door Size: N/A

Interior Door Size: Up to 30"



White



Matte Black

Parallel Arm (Push Side) Mounting (Cover Not Shown)

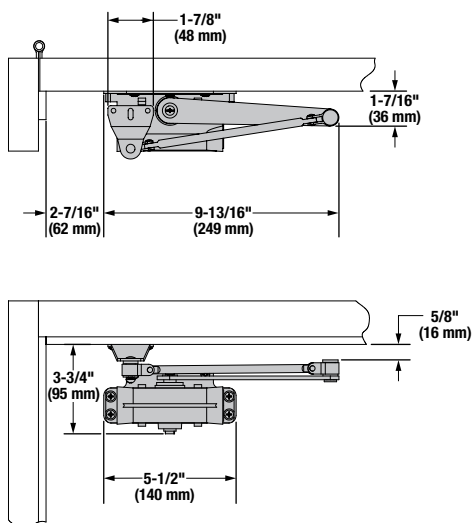

Opening Angle	A		B	
	in	mm	in	mm
120°	4-15/16	125	8-5/16	211
155°	2-3/16	56	5-9/16	141

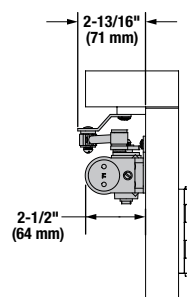

Locksets



Grade 2 Cylindrical Passage Lever



Grade 2 Knob and Deadbolt Combo

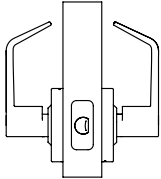
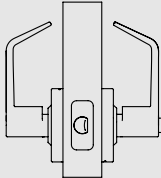
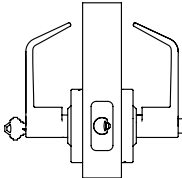
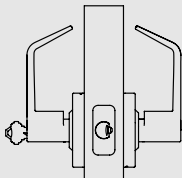

Lever/Knob Functions

Outside/Inside	Function	ANSI No	Function Description
	Passage	F75	The Passage lever has a latchbolt that is operated by the lever from either side at all times. It does not have a lock function.
	Privacy	F76	The Privacy lever has a latchbolt that is operated by the lever from either side, except when the outside lever is locked by the turn button inside. An emergency release on the outside unlocks the locking device. The turn button must be in the unlocked position for the outside or inside lever to operate.
		F76A (Panic release)	ANSI F76A (Panic release): The privacy lever has a latch bolt that's operated by the lever from either side, except when the outside lever is locked by the push button inside. An emergency release on the outside unlocks the locking device. Inside lever is always free for immediate egress.
		F76B (Non-Panic release)	ANSI F76B: Privacy Lock (non-panic release): Latchbolt operated by lever from either side except when outside lever is locked by turn button inside. Emergency release on outside unlocks locking device. Turn button shall be in unlocked position for outside or inside lever to operate latch bolt.
	Keyed Entry	F81	F81: Entry Lock Deadlocking latchbolt operated by lever from either side except when outside lever is locked by turn button inside. Operating key in outside lever locks or unlocks locking device. Turn button shall be in unlocked position for outside or inside lever to operate latch bolt.
		F82B	F82B: Entry Lock Deadlocking latchbolt operated by knob or lever from either side except when outside knob/lever is locked by turn button or push button inside. Operating key in outside knob/lever unlocks locking device. Operating inside knob/lever unlocks locking mechanism and operates latch bolt.
		F109	F109: Entry Lock (dual locking functionality) Deadlocking latchbolt operated by lever from either side except when outside lever is locked by turn button or push button inside. Operating key in outside lever or operating inside lever releases the push or turn button unlocking outside lever except when push or turn button has been both pushed and rotated to keep outside lever locked. When pushed and rotated, inside push or turn button must be manually operated to unlock outside lever. Inside lever is always free.
	Keyed Entry- Storeroom	F86	The Keyed Entry – Storeroom lever has a deadlocking latchbolt operated by a key in the outside lever or by rotating the inside lever. The outside lever is always locked. The Keyed Entry – Storeroom lever has a deadlocking latchbolt operated by a key in the outside lever or by rotating the inside lever. The outside lever is always locked.

Light Duty



**3 HOUR
FIRE
RATED**



FUNCTION	FINISH	MFG SKU	MFG SKU
Dummy/Inactive	Satin Chrome	UH40068	
Passage (F75)	Satin Chrome	UH40047	1002273995
Passage (F75)	Matte Black	UH40101	1008143800
Privacy (F76A)	Satin Chrome	UH40048	1002274004
Privacy (F76A)	Matte Black	UH40100	1008143801
Keyed Entry (F82B)	Satin Chrome	UH40049	1002274006
Keyed Entry (F82B)	Matte Black	UH40098	1008143785
Storeroom (F86)	Satin Chrome	UH40050	1002273996
Storeroom (F86)	Matte Black	UH40099	1008143793



Satin Chrome



Matte Black

Keying Options: Grand Master Key (GMK), Builder Master Key (BMK), Master Key (MK), Maison Key (MK), Keyed Different (KD), Keyed Alike (KA)

Specifications:

ANSI Grade 2

UL 3-Hour Fire Rated

Adjustable backset: 2-3/8" and 2-3/4"

Rosette Diameter: 2-5/8"

Finishes: Satin Chrome, Matte Black

Lever Handle Length: 4-1/8"

Chassis: Tubular

Door range: 1-3/8" to 1-3/4"

Keyway: SC1, 5 pin

Strikes: T-strike (1-1/8" x 2-3/4")
and full lip (1-3/4" x 2-1/4")

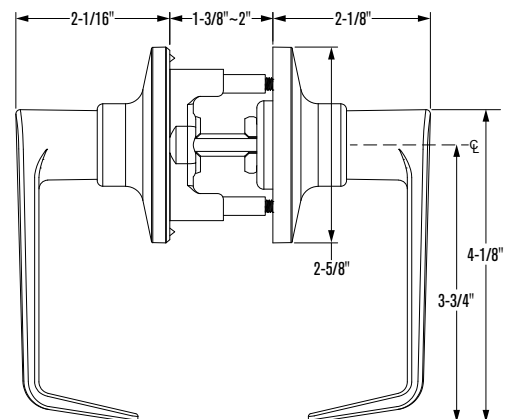

Heavy Duty



Flat Lever

FUNCTION	FINISH	MFG SKU	HD SKU
Passage (F75)	Satin Chrome	UH40017	262611
Privacy (F76)	Satin Chrome	UH40018	262908
Keyed Entry (F109)	Satin Chrome	UH40019	263634
Classroom (F84)	Satin Chrome	UH40045	1002273999
Storeroom (F86)	Satin Chrome	UH40046	1002274005

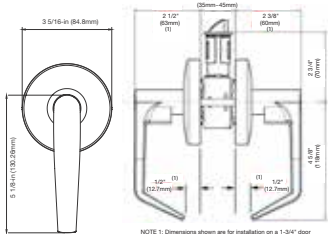

Specifications:

ANSI Grade 2
UL 3-Hour Fire Rated
Fixed backset: 2-3/4"
Rosette Diameter: 3-5/16"
Finish: Satin Chrome
Lever Handle Length: 5-1/8"
Chassis: Cylindrical
Door range: 1-3/8" to 2"
Keyway: SC4, 6 pin
Strikes: T-strike (1-1/8" x 2-3/4") and
ASA Strike (1-1/4" x 4-7/8")

Curved Lever

FUNCTION	FINISH	MFG SKU	HD SKU
Passage (F75)	Satin Chrome	UH40129	1008127198
Privacy (F76)	Satin Chrome	UH40128	1008127205
Keyed Entry (F109)	Satin Chrome	UH40126	1008127200
Storeroom (F86)	Satin Chrome	UH40127	1008143791



Keying Options: Grand Master Key (GMK), Builder Master Key (BMK), Master Key (MK), Maison Key (MK), Keyed Different (KD), Keyed Alike (KA)

Industrial Duty



**3 HOUR
FIRE
RATED**



FUNCTION	FINISH	MFG SKU
Passage (F75)	Satin Chrome	UH40021
Privacy (F76)	Satin Chrome	UH40022
Keyed Entry (F109)	Satin Chrome	UH40023
Storeroom (F86)	Satin Chrome	UH40025



Specifications:

ANSI Grade 1

UL 3-Hour Fire Rated

Fixed backset: 2-3/4"

Rosette Diameter: 3-9/16"

Finish: Satin Chrome

Lever Handle Length: 5-5/8"

Chassis: Cylindrical

Door range: 1-3/8" to 2-1/4"

Keyway: SC4, 6 pin

Strikes: T-strike (1-1/8" x 2-3/4") and
ASA Strike (1-1/4" x 4-7/8")

Keying Options: Grand Master Key (GMK), Builder Master Key (BMK), Master Key (MK), Maison Key (MK), Keyed Different (KD), Keyed Alike (KA)

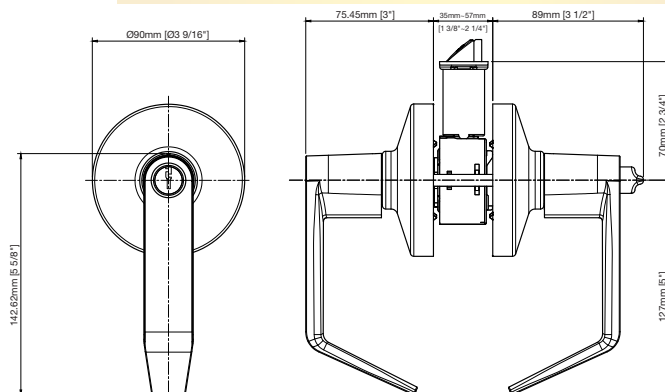



Heavy Duty

Lever



3 HOUR
FIRE
RATED



Deadbolt



FUNCTION	FINISH	MFG SKU	HD SKU
Keyed Entry Lever (F109) and Deadbolt Combo	Satin Chrome	UH40032	1001645241

Deadbolt and Lever are keyed alike

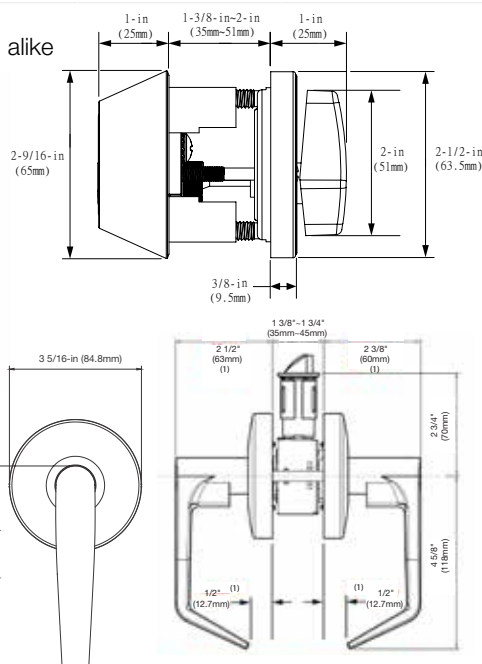

NOTE 1: Dimensions shown are for installation on a 1-3/4" door

Lever Specifications:

ANSI Grade 2

UL 3-Hour Fire Rated

Fixed backset: 2-3/4"

Rosette Diameter: 3-5/16"

Finish: Satin Chrome

Lever Handle Length: 5-1/8" (tip to tip)

Chassis: Cylindrical

Door range: 1-3/8" to 2"

Keyway: SC4, 6 pin

Strikes: T-Strike (1-1/8" to 2-3/4") and
ASA Strike (1-1/4" x 4-7/8")

Deadbolt Specifications:

ANSI Grade 1

UL 3-Hour Fire Rated

Adjustable backset: 2-3/8" or 2-3/4"

Rosette Diameter: 2-1/2"

Finish: Satin Chrome

Thumbturn Length: 2"

Door range: 1-3/8" to 2"

Keyway: SC4, 6 pin

Strikes: Rectangular with Square
corners (1-1/8" x 2-3/4")

Reinforcement Plate: Rectangular with
round corners (1-1/8" x 2-3/4")

Keying Options: Grand Master Key (GMK), Buil
Key (BMK), Master Key (MK), Maison Key (MK)
Different (KD), Keyed Alike (KA)



FUNCTION	FINISH	MFG SKU
Keyed Entry	Satin Chrome	UH40107



Specifications:

ANSI Grade 2

Adjustable backset: 2-3/8" and 2-3/4"

Finishes: Satin Chrome

Lever Handle Length: 3-3/4"

Door range: 1-3/8" to 2"

Keyway: SC4, 6 pin

Cylinder: Brass

Strikes: Full lip (1-3/4" x 2-1/4")

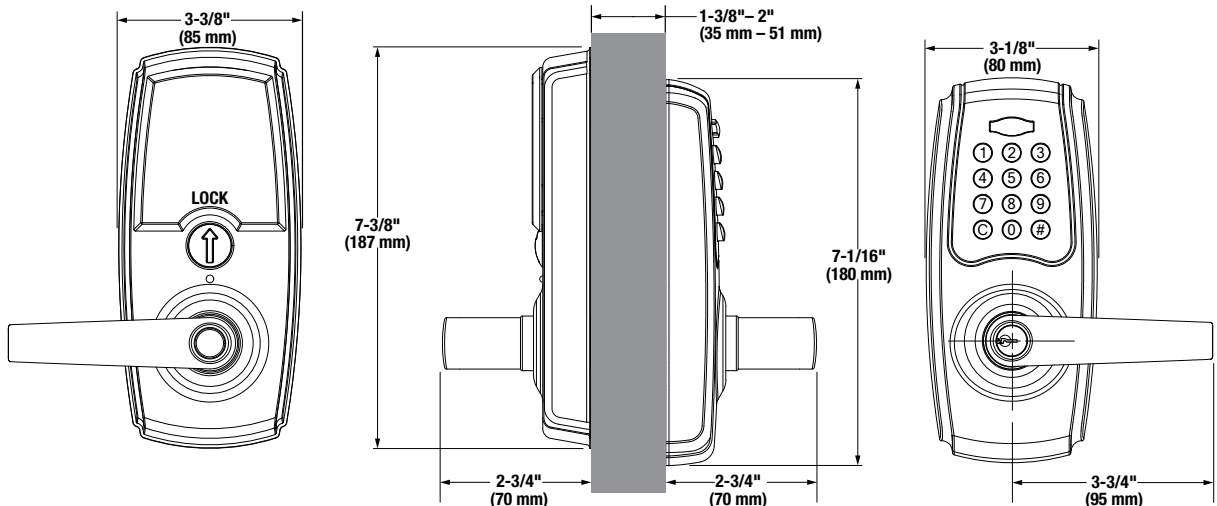

Light Duty



3 HOUR
FIRE
RATED



FUNCTION	FINISH	MFG SKU	HD SKU
Passage (F75)	Satin Chrome	UH40051	1002273998
Passage (F75)	Matte Black	UH40105	1008143782
Privacy (F76A)	Satin Chrome	UH40057	1002746877
Privacy (F76A)	Matte Black	UH40104	1008127197
Keyed Entry (F2B)	Satin Chrome	UH40052	1002274007
Keyed Entry (F81)	Matte Black	UH40102	1008143788
Storeroom (F86)	Satin Chrome	UH40053	1002273991
Storeroom (F86)	Matte Black	UH40103	1008143787

Specifications:

ANSI Grade 2
UL 3-Hour Fire Rated
Adjustable backset: 2-3/8" and 2-3/4"
Rosette Diameter: 2-5/8"
Finishes: Satin Chrome & Matte Black
Chassis: Tubular
Door range: 1-3/8" to 1-3/4"
Keyway: SC1, 5 pin
Strikes: T-strike (1-1/8" x 2-3/4") and full lip (1-3/4" x 2-1/4")

Keying Options: Grand Master Key (GMK), Builder Master Key (BMK), Master Key (MK), Maison Key (MK), Keyed Different (KD), Keyed Alike (KA)



Satin Chrome



Matte Black

Light Duty



**3 HOUR
FIRE
RATED**



Knob



Deadbolt



FUNCTION	FINISH	MFG SKU	HD SKU
Keyed Entry & Deadbolt Combo (F76)	Satin Chrome	UH40054	1002273997
Keyed Entry & Deadbolt Combo (F76)	Matte Black	UH40106	1008143786

Knob and Deadbolt are keyed alike



Satin Chrome



Matte Black

Specifications:

ANSI Grade 2

UL 3-Hour Fire Rated

Adjustable backset: 2-3/8" and 2-3/4"

Finishes: Satin Chrome, Matte Black

Rosette Diameter: (Knob) 2-5/8"

Knob Chassis: Tubular

Door range: 1-3/8" to 1-3/4"

Keyway: SC1, 5 pin

Strikes: T-strike (1-1/8" x 2-3/4") and full lip (1-3/4" x 2-1/4") (included)

Deadbolt Strike: 1-1/8" x 2-3/4"

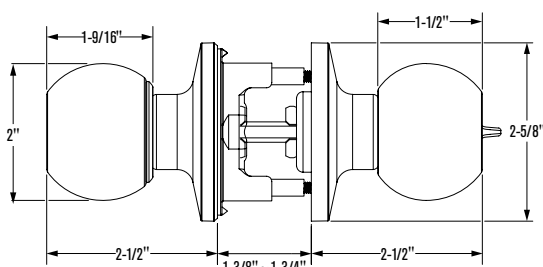
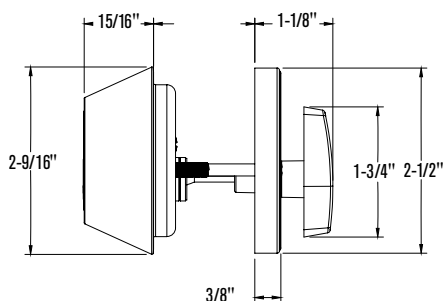

Industrial Duty



3 HOUR
FIRE
RATED



FUNCTION	FINISH	MFG SKU	HD SKU
Single Cylinder Deadbolt	Satin Chrome	UH40055	1002274000
Single Cylinder Deadbolt	Matte Black	UH40130	1008143783

Single Cylinder Deadbolt



FUNCTION	FINISH	MFG SKU	HD SKU
Double Cylinder Deadbolt	Satin Chrome	UH40056	1002274002

Double Cylinder Deadbolt



Keying Options: Grand Master Key (GMK), Builder Master Key (BMK), Master Key (MK), Maison Key (MK), Keyed Different (KD), Keyed Alike (KA)

Specifications:

Grade 1

UL 3-Hour Fire Rated

Adjustable backset: 2-3/8" and 2-3/4"

Finishes: Satin Chrome, Matte Black

Door range:

Single Cylinder 1-3/8" to 2"

Double Cylinder 1-9/16" to 2"

Keyway: SC4, 6 pin

Cylinder: Brass

Strikes: Square Strike (1-1/8" x 2-3/4") and reinforcement plate

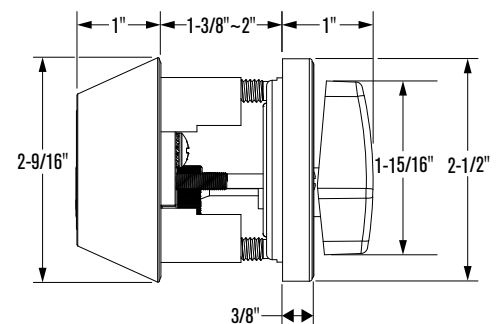



FINISH	MFG SKU	HD SKU
Satin Chrome	UH40131	1008127199

Specifications:

ANSI Grade 2

Adjustable backset: 2-3/8" and 2-3/4"

Finish: Satin Chrome

Door range: 1-3/8" to 1-3/4"

Strikes: Square strike (1-1/8" x 1-3/4") and reinforcement plate

Grade 2 Indicator Deadbolt

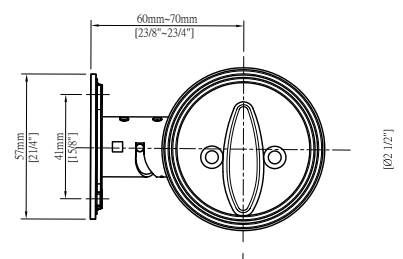
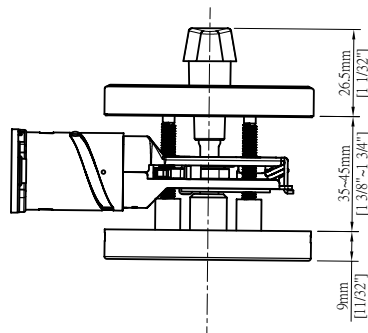
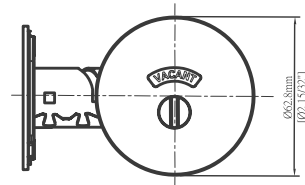

Exit Device (and accessories)





c



FINISH	MFG SKU	HD SKU
Aluminum	UH40010	310263
Matte Black	UH41015	1010212535

Exit Device



Applications

Compare to Von Duprin 22 Series

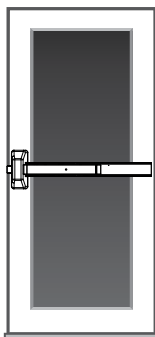

Single rim device

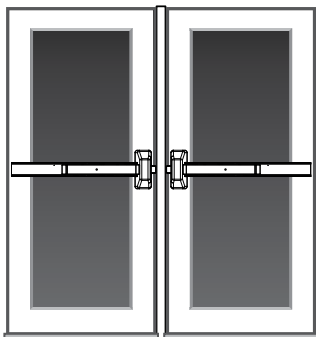

Two rim devices with mullion — same direction

Specifications:

ANSI Grade 1

UL Listed: 305 Compliant

Door width range: 28" to 42"

36" – 42" door width range without modification 28" – 35" door width range with cutting of the rail frame. 30" minimum door width for a double door + mullion installation

Head Cover Dimensions: 8-1/2" x 2-3/4" x 2-1/2"

Push bar projection: 2-1/2" (push bar neutral)
1-15/16" (push bar depressed)

Door thickness range: 1-3/4" – 2"

Latch bolt: Deadlocking with 5/8" projection

Dogging device: Yes, hex key included

ADA Compliant: Yes - Device only or with KIL Lever Trim

Cylinder keyway: SC4 , 6-Pin

Strikes: Surface mounted strike with 1/8" strike shim

Finishes: Aluminum, Matte Black

Included: Brass rim cylinder and steel pull

Stile: Wide



FUNCTION	FINISH	MFG SKU	HD SKU
M91P Exit Device	Satin Stainless Steel	UH41030	039208251341



M91P is a direct match to Von Duprin's 99 Series footprint and performance specifications

Applications

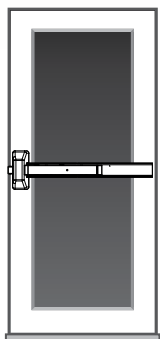

Single rim device

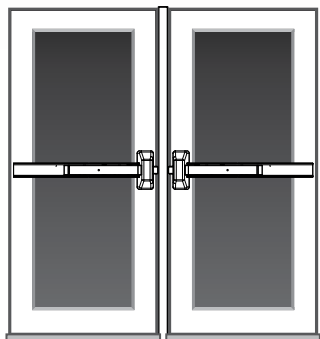

Two rim devices with mullion — same direction

Specifications:

ANSI Grade 1
 UL Listed: 305 Compliant
 ADA Compliant: Yes
 Dogging: Yes, hex key provided
 Reversible: Yes
 Door Width Range: 28" to 36"
 Head Cover Dimensions: 8" x 2-3/4"
 Device Length: 33"
 Push Bar Length: 18"
 Push Bar Projection: 3-13/16" neutral, 3-1/16" depressed
 Door Thickness: 1-3/4" to 2-1/4"
 Latch Bolt: 3/4" throw, deadlocking
 Strike: 2-7/8" roller strike
 Damper: Fluid filled quiet damper
 Warranty: 10 year limited
 Finish: Satin Stainless Steel
 Included: Brass cylinder with tailpiece, SC4 6-pin, and device end cap.



* Cylinder not included with pull handle. Cylinder included with UH40010

FUNCTION	FINISH	MFG SKU	HD SKU
Exit Device Trim	Satin Chrome	UH40011	310659

Exit Device Trim

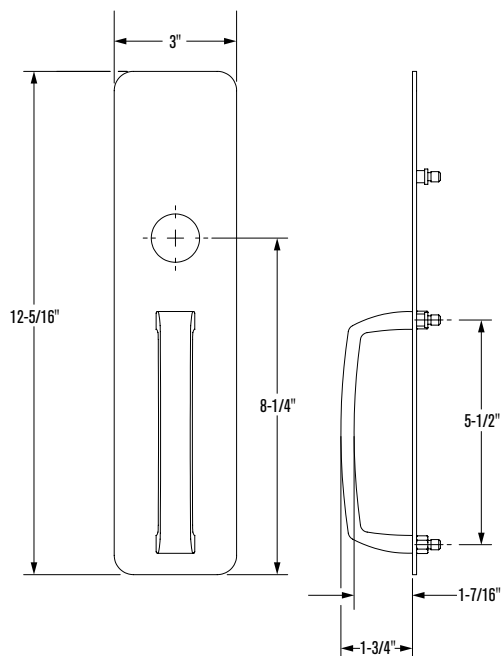

Specifications:

Trim function: Pull Handle

Function description: Key retracts bolt (cylinder included with UH40010 or UH41015); Cylinder sleeve included for 161 door prep

Escutcheon plate size: 12-5/16" x 3"

Pull center to center: 5-1/2"

Projection: 1-3/4"

Finish: Satin Chrome

Handing: Reversible

Through-bolt design

Night latch function: Yes

Door thickness range: 1-3/4" to 2"

Flat Goods & Accessories

A close-up photograph of a brushed stainless steel pull plate mounted on a light-colored wood-grain door. The plate is rectangular with a curved handle. In the background, a window with multiple panes is visible, showing a blurred outdoor scene with greenery.

Stainless Steel Pull Plate

A close-up photograph of a black privacy door latch mounted on a white door. The latch has a rectangular faceplate with a small window and a cylindrical handle. It is secured with three screws on the side.

Privacy Door Latch

A close-up photograph of a white, circular door silencer mounted on a grey door. The silencer is attached to the door with a single screw. Below it, a portion of a metal door handle is visible.

Door Silencers

FUNCTION	FINISH	MFG SKU	HD SKU
Floor Mount Door Stop	Satin Chrome	UH40074	1003126920
Floor Mount Door Stop	Matte Black	UH41019	1010212415



Specifications:

Base Material: Solid cast brass

Diameter: 1-3/4"

Height without riser: 1-1/8"

Height with riser: 1-1/2"

Fasteners: (1) #12 x 1-1/2" Wood Screw, (1) 1/4"-20 x 1" Machine Screw

Finishes: Satin Chrome, Matte Black

Bumper: Rubber

Mounting: Floor mounted

FUNCTION	FINISH	MFG SKU	HD SKU
Floor Mount Door Stop with Holder	Satin Chrome	UH40076	1003136371
Floor Mount Door Stop with Holder	Matte Black	UH40108	1010292711



Specifications:

Base Material: Solid cast brass

Diameter: 2-1/2"

Height: 3-1/2"

Fasteners: (3) #12 x 1-1/2" Wood Screws, (1) 5/16"-18 Fully Threaded Rod

Finishes: Satin Chrome, Matte Black

Bumper: Rubber

Mounting: Floor mounted

FUNCTION	FINISH	MFG SKU	HD SKU
Kick Down Floor Stop	Satin Chrome	UH41009	1010212436
Kick Down Floor Stop	Matte Black	UH41020	1010212422



Specifications:

Base Material: Solid cast brass

Height: 4"

Bumper Diameter: 1"

Fasteners: (4) #8 x 1" Wood Screws

Finishes: Satin Chrome, Matte Black

Bumper: Rubber

Mounting: Door mounted

FUNCTION	FINISH	MFG SKU	HD SKU
Hands Free Foot Door Opener	Stainless Steel	4120-630	1005701593



Specifications:

Material: Stainless Steel

Size: 5" x 1-1/4"

Finish: Stainless Steel

Fasteners: (3) #6 x 5/8" Wood Screws

FUNCTION	FINISH	MFG SKU	HD SKU
Commercial Grip with Arm Door Opener	Stainless Steel	4130-630	005701595



Specifications:

Material: Stainless Steel

Size: 4" x 16"

Finish: Stainless Steel

Fasteners: (6) #6 x 5/8" Wood Screws

FUNCTION	FINISH	MFG SKU	HD SKU
Hands Free Arm Door opener	Stainless Steel	4131-630	1005701597



Specifications:

Material: Stainless Steel

Size: 2" x 6"

Finish: Stainless Steel

Fasteners: (4) #6 x 5/8" Wood Screws

FUNCTION	MFG SKU	HD SKU
Door Silencers	UH41013	1010212430



Specifications:

Material: Rubber

Diameter: 1/2"

Height: 1/2"

Pack of 12

FUNCTION	FINISH	MFG SKU	HD SKU
ASA Strike	Satin Chrome	UH41012	1010212433
ASA Strike	Matte Black	UH41014	1010212429



Specifications:

Base Material: Stainless Steel

Height: 4-7/8"

Width: 1-7/8"

Fasteners: #12 x 3/4" Combo Screws

Finishes: Satin Chrome, Matte Black



FUNCTION	FINISH	MFG SKU	HD SKU
Privacy Door Latch	Satin Chrome	UH40092	1004647012
Privacy Door Latch	Bronze	UH40093	1004647018



Specifications:

Base Material: Zinc Alloy

Height: 2.75"

Fasteners: (3) # 12x 1-3/4" Wood Screws

Finishes: Satin Chrome, Bronze

Mounting: Frame Mounted

FUNCTION	FINISH	MFG SKU	HD SKU
4 1/2" Ball Bearing Door Hinge	Prime Coated	UH41010	1010212539
4 1/2" Ball Bearing Door Hinge	Satin Chrome	UH41011	1010212538
4 1/2" Ball Bearing Door Hinge	Matte Black	UH41018	1010212540

Hinges meet the requirements of NFPA 80 Section 6.4.3.1 for use on fire rated doors up to 4 ft wide by 8 ft high and 1-3/4" thick.

Specifications:

Material: Steel (ANSI A8112)

Gauge of Metal: .134"

Dimensions: 4-1/2" x 4-1/2"

Finishes: Prime Coated (UH41010),
Satin Chrome (UH41011),
UH41018 (Matte Black)

Swaging: 1/16" Swage standard which provides 1/16" of clearance between leaves



FUNCTION	FINISH	MFG SKU	HD SKU
Spring Hinge	Satin Chrome	UH40079	1001537553



Specifications:

Material: Steel

Gauge: .140"

Dimensions: 4-1/2" x 4-1/2"

Finish: Satin Chrome

Tension-Adjustable

Swaging: 1/16"

FUNCTION	FINISH	MFG SKU	HD SKU
Spring Hinge Pack	Satin Chrome	UH40132	1010212425



Specifications:

Material: Steel

Gauge: .134"

Dimensions: 4-1/2" x 4-1/2"

Finish: Satin Chrome

Swaging: 1/16"

FUNCTION	FINISH	MFG SKU	HD SKU
Pull Handle	Aluminum	UH40069	1010212412



Specifications:

Material: 304 Aluminum

Application: Wood, glass, fiberglass and metal doors

Finish: Aluminum

Hardware: (6) #8 x 1" sheet metal screws

FUNCTION	FINISH	MFG SKU
Restroom Slide Latch	Stainless Steel	UH40117



Specifications:

Material: SUS 304

Application: Wood or metal doors

Finish: Stainless Steel

Bolt Extension: 1" (25mm)

Hardware: (4) M5 x 3/4" sheet metal screws

FUNCTION	FINISH	MFG SKU	HD SKU
Restroom Indicator Latch	Satin Nickel	UH40118	1010212424



Specifications:

Material: SUS 201 (Plastic indicator)

Application: Wood or metal doors

Finish: Satin Nickel

Bolt Extension: 3/4"

Hardware: (6) #7 x 1" sheet metal screws, (2) 19/32" sheet metal screws

FUNCTION	FINISH	MFG SKU	HD SKU
Restroom Door Hook	Satin Stainless Steel	UH40119	1010212423



Specifications:

Material: SUS 304

Application: Wood or metal doors

Finish: Satin Stainless Steel

Projection: 2"

Hardware: (2) #7 3/4" sheet metal screws

Pull/Push/Kick Plates



Stainless Steel Pull Plate



Aluminum Push Plate

FUNCTION	FINISH	MFG SKU	HD SKU
Pull Plate	Stainless Steel	UH41004	1010212428



Specifications:

Material: Stainless Steel

Size: 4" x 16"

Finish: Stainless Steel

Handle CTC: 6"

Fasteners: (6) #6 x 3/4" Wood Screws

FUNCTION	FINISH	MFG SKU	HD SKU
Pull Plate	Aluminum	UH41006	1010212434
Pull Plate	Matte Black	UH41021	1010212431



Specifications:

Material: Aluminum

Size: 3-1/2" x 15"

Finishes: Aluminum (UH41006),
Matte Black (UH41021)

Handle CTC: 5-1/8"

Fasteners: (6) #6 x 3/4" Wood Screws

FUNCTION	FINISH	MFG SKU	HD SKU
Push Plate	Stainless Steel	UH41005	1010212437
Push Plate	Aluminum	UH41007	1010212421
Push Plate	Matte Black	UH41022	1010212417



Specifications:

Material: Stainless Steel (UH41005);
Aluminum

Size: 3-1/2" x 15"

Finishes: Stainless Steel (UH41005),
Satin Aluminum (UH41007), Matte Black
(UH41022)

Fasteners: (6) #6 x 3/4" Wood Screws

FUNCTION	FINISH	MFG SKU	HD SKU
Push Plate	Stainless Steel	UH41003	1010212414
Push Plate	Matte Black	UH40135	1010292710



Specifications:

Material: Stainless Steel

Size: 8" x 16"

Finishes: Stainless Steel (UH41003),
Matte Black (UH40135)

Fasteners: (6) #6 x 3/4" Wood Screws

FUNCTION	FINISH	MFG SKU	HD SKU
8"x34" Kickplate	Satin Aluminum	UH41002	1010212413
8"x34" Kickplate	Matte Black	UH40134	1010212419
10"x34" Kickplate	Stainless Steel	UH40070	1001537556
10"x34" Kickplate	Matte Black	UH40136	1010212435

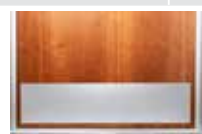

Specifications:

Material: : Aluminum (UH41002 &
UH40134) Stainless Steel (UH40070 &
UH40136)

Size: 8"x34" (UH41002 & UH40134)

10"x34" (UH40070 & UH40136)

Fasteners: (6) #6 x 3/4" wood screws

Door Handles



C-Style Pull Handle

FUNCTION	FINISH	MFG SKU	HD SKU
Pull Handle	Stainless Steel	UH40094	1004647013
Pull Handle	Matte Black	UH40178	1010212537



Specifications:

Material: 304 Grade stainless steel

Application: Wood, glass, fiberglass and metal doors

Pull center to center: 11"

Tube Diameter: 1"

Projection: 2-3/4"

Door thickness range: 1/4" (glass) to 2"

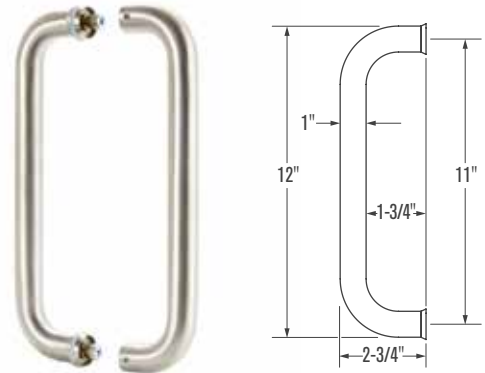

"C" Style Pull Handle

FUNCTION	FINISH	MFG SKU	HD SKU
Pull Handle	Stainless Steel	UH40095	1004647020
Pull Handle	Matte Black	UH40179	1010212534



Specifications:

Material: 304 Grade stainless steel

Application: Wood, glass, fiberglass and metal doors

Pull center to center: 6"

Tube Diameter: 1"

Projection: 3"

Door thickness range: 1/4" (glass) to 2"

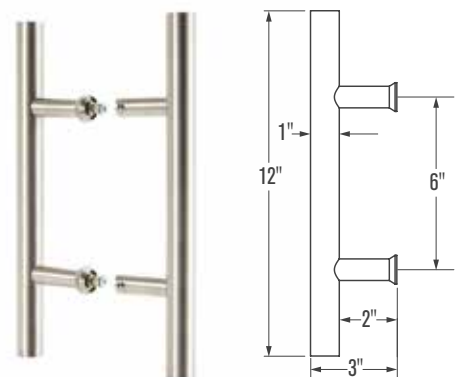

"H" Style Pull Handle

universalhardware.com
(833)-343-5625



50 Icon, Foothill Ranch, CA 92610-3000
©2026 Hampton Products International Corp.
84000-00025_REV01 01/26